



RT 773

Energetic diffuse reflection light scanners



Dimensioned drawing

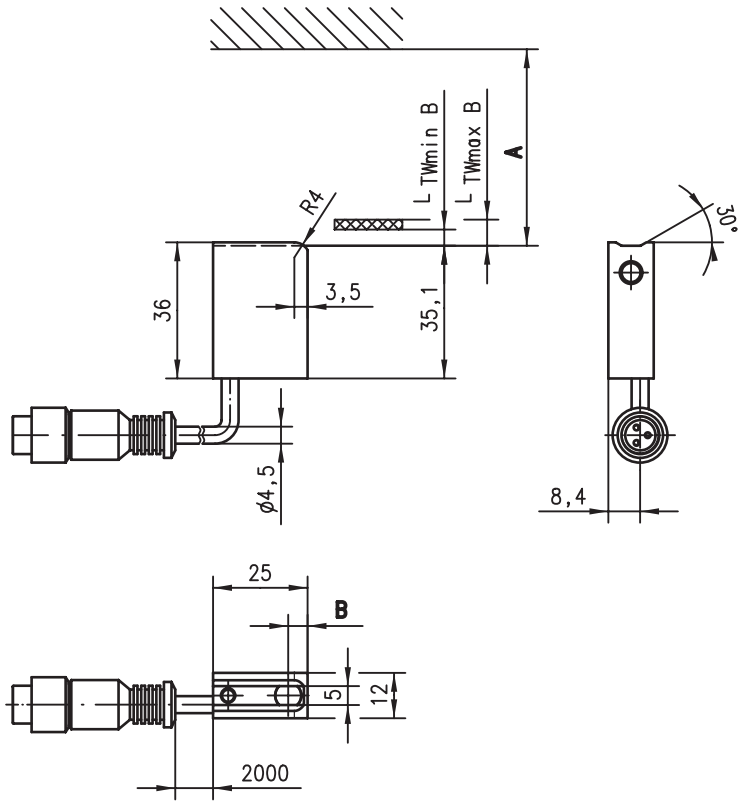

- A Free space
- B Switching point



0 ... 5 mm



- Miniature construction with completely integrated electronics
- The PNP transistor output is short-circuit proof and polarity reversal protected
- Immersed optical cover for mechanical protection
- Pollution resistant through specially designed optics

Electrical connection

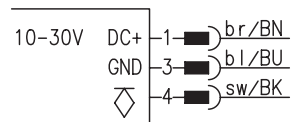

Accessories:

We reserve the right to make changes • ms_c08e.fm



Specifications

Optical data

Scanning range (white 90%) 0 ... 5mm
 Light source LED (modulated light)
 Wavelength 880nm

Timing

Switching frequency 300Hz
 Response time 1.65ms
 Delay before start-up ≤ 100ms

Electrical data

Operating voltage U_B 10V ... 30VDC
 Residual ripple ≤ 10% of U_B
 Bias current ≤ 20mA
 Switching output PNP transistor output
 Function characteristics light switching
 Signal voltage high/low $\geq (U_B - 2V) / \leq 2V$
 Output current 100mA

Mechanical data

Housing aluminium anodised, black
 Optics cover glass
 Weight approx. 30g
 Connection type cable with M12 connector,
 cable length: 2000mm

Environmental data

Ambient temp. (operation/storage) 0°C ... +50°C / -30°C ... +60°C
 Protective circuit ¹⁾ 2, 3
 VDE safety class III
 Protection class IP 65
 Standards applied IEC 60947-5-2

1) 2=polarity reversal protection, 3=short-circuit protection for all outputs

Tables

Scanning range	mm	Reflectance factor
L _{TWminB}	0.8	6%
L _{TWmaxB}	3.5	6%
L _{TWminB}	5.0	90%
Free space	8.0	≤ 90%
Switching point	~ 5.0	6%
Switching point	~ 5.5	90%
Switching point is determined with L _{TW} = 1 mm		

Diagrams

Order guide

Designation	Part No.
RT 773/4-4	500 38524

Remarks

- Typical application: Paper edge detection in printing machines
- The upper and lower scanning range limit varies depending on the reflection properties of the material surface.