

RK 756

Energetic diffuse reflection light scanner

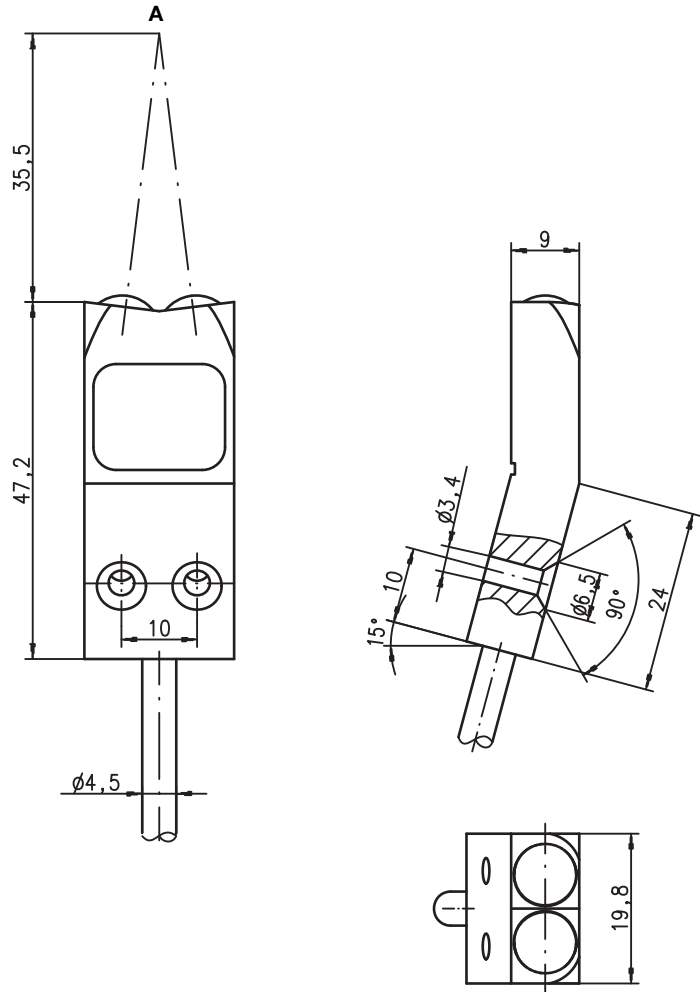

Dimensioned drawing



35 mm



- Application-specific construction
- Small construction volume enables application in small spaces
- High insensitivity towards soiling and shocks
- Can be optimally adapted to the application through selection of appropriate amplifier
- Narrow light beam

A Focus

Electrical connection

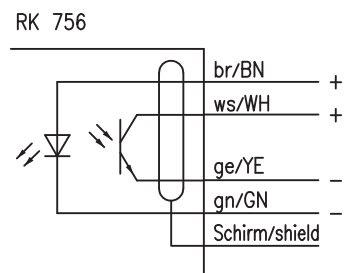

We reserve the right to make changes • MS_c11gb.fm



Accessories:

(available separately)

- Amplifier for mini photoelectric sensors, e.g.
 - VS 9/1 (Part No. 500 00632)
 - IVS 9/4.8 (Part No. 500 12303)
 - VS 27/24 (Part No. 500 82005)
 - IVS 28/44.8 (Part No. 500 19808)

Specifications

Optical data

Scanning range (white 90%) 1)	30 ... 40mm
Light source	LED (modulated light)
Wavelength	880nm

Electrical data

Transmitter	GaAs
Transmitting current	max. 200mA at D=0.05
Receiver	Si phototransistor
Blocking voltage U _{CEO}	max. 35VDC

Mechanical data

Housing	red aluminium, anodised
Optics	glass
Weight	approx. 70g
Cable length	4000mm
Cable cross-section	4x0.14mm ² +shield

Environmental data

Ambient temp. (operation/storage)	-20°C ... +60°C/- 30°C ... +70°C
Protection class	IP 65

1) The scanning range depends on the choice and on the sensitivity adjustment of the respective amplifier

Tables

Diagrams

Order guide

Designation	Part No.
RK 756	500 12831

Remarks

- **Approved purpose:**
The diffuse reflection light scanner is specially designed for stack detection in feeders.
- The upper and lower scanning range limit varies depending on the reflection properties of the material surface.
- If cable lengthening should be necessary, make sure that the shield is continued without interruption.