

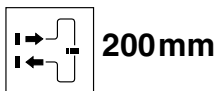

Plastic fibre optics in throughbeam operation



Dimensioned drawing



200mm



- Plastic fibre optics in throughbeam operation
- Fibre optics with various cross sections and end pieces
- Length can be cut by the user
- Connection pieces suitable for fibre optic amplifiers LVS 420/P, LVSR 8 and LVSR 325
- With ".5" versions, the end piece is bendable and can be adjusted to every mounting position

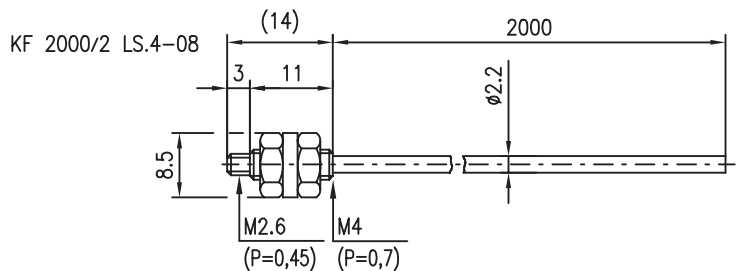
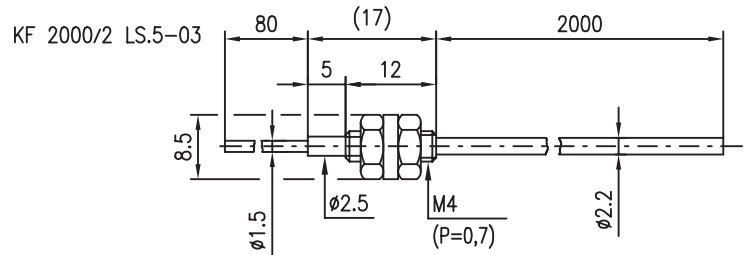
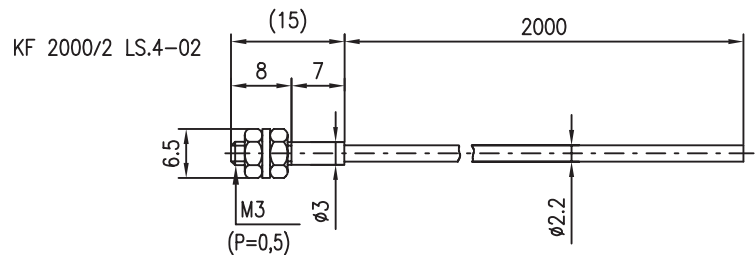
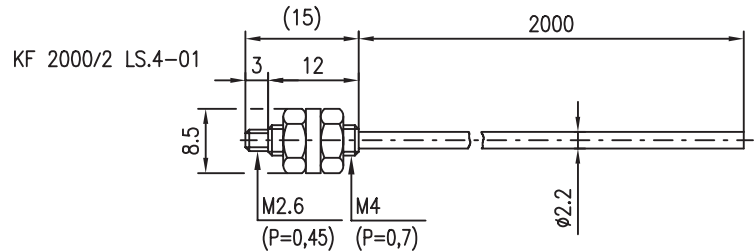

KF - L1

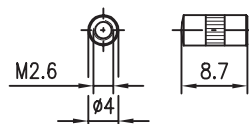

KF - U1

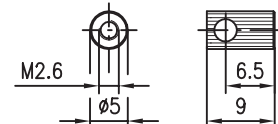

We reserve the right to make changes • lsg_e09e.fm

Accessories:

(available separately)

- Angles and optics attachments
 - KF-L1 (Part No. 500 34065)
 - KF-U1 (Part No. 500 34064)

(part of the delivery contents)

- Fibre optics cutting device (except for KF 2000/2 LS.4-08)
- Adapter (for fibre optics with Ø1 mm)



Plastic fibre optics in throughbeam operation

Specifications

Optical data

Standard length	2000mm
Reinforcement	PVC
Operating temperature	-25 °C ... +80 °C
Minimum bending radius	15mm

Remarks

- Mounting**
 When mounting the fibre optics, a minimum bending radius of 15mm must be guaranteed for reliable function. Moreover, the fibre optics must not be bent within 15mm of the sensor and cable head. The minimum bending radius of the stainless steel sleeve on the cable head is 10mm.
- Connection**
 The fibre optics must be inserted securely into the corresponding openings in the control device (connection length approx. 15mm). The fastening screw is used for fixation of the fibre optics.
- Cutting**
 The plastic fibre optics can be cut to the desired length using the fibre optics cutting device. Each cut opening may only be used once.
- Adapter**
 The included adapter must be used with fibre optics having a fibre diameter of 1mm. The fibre optics must extend more than 0.5mm beyond the adapter.
- First installation**
 Before using the fibre optics for the first time, the fibre must be cut at the end to provide a smooth surface.
- Optical attachments**
 Screw-on type for KF 2000/2 LS.4-01 (throughbeam operation). With optical attachment KF-L1 for longer operating ranges. With optical attachment KF-U1 for 90° deflection. Operating range see table.
- Shipment is done in pairs for throughbeam (LS) applications.**

Order guide

Plastic fibre optics in throughbeam operation

Order code	KF 2000/2 LS.4-01 Part No. 500 27775 KF 2000/2 LS.4-08 Part No. 500 35309		KF 2000/2 LS.4-02 Part No. 500 27780	KF 2000/2 LS.5-03 Part No. 500 27781
		KF-L1	KF-U1	
Operating range ¹⁾	80mm	800mm	100mm	100mm
Operating range ²⁾	200mm	2500mm	250mm	200mm
Operating range ³⁾	200mm	2000mm	200mm	200mm
Fibre optics outer diameter	2mm			2mm

1) Operating range in connection with LVS 420/P
 2) Operating range in connection with LVSR 325
 3) Operating range in connection with LVSR 8



Plastic fibre optics in scanner operation



Dimensioned drawing

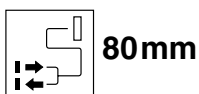

80 mm



KLL

- Plastic fibre optics in scanner operation
- Fibre optics with various cross sections and end pieces
- Length can be cut by the user
- Connection pieces suitable for fibre optic amplifiers LVS 420/P, LVSR and LVSR 325
- With ".5" versions, the end piece is bendable and can be adjusted to every mounting position

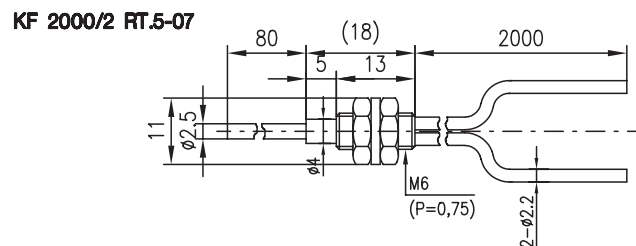
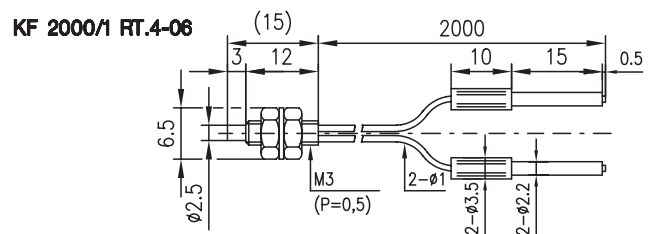
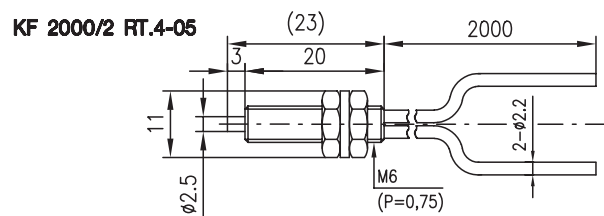
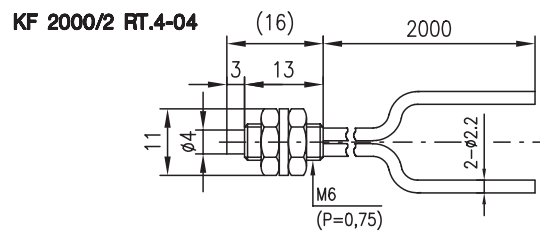

We reserve the right to make changes • lsg_e09e.fm

Accessories:

(part of the delivery contents)

- Fibre optic cutting device
- Adapter (for fibre optics with $\varnothing 1$ mm)



Plastic fibre optics in scanner operation

Specifications

Optical data

Standard length	2000mm
Reinforcement	PVC
Operating temperature	-25 °C ... +80 °C
Minimum bending radius	15mm

Remarks

- **Mounting**
When mounting the fibre optics, a minimum bending radius of 15mm must be guaranteed for reliable function.
Moreover, the fibre optics must not be bent within 15mm of the sensor and cable head.
The minimum bending radius of the stainless steel sleeve on the cable head is 10mm.
- **Connection**
The fibre optics must be inserted securely into the corresponding openings in the control device (connection length approx. 15mm).
The fastening screw is used for fixation of the fibre optics.
- **Cutting**
The plastic fibre optics can be cut to the desired length using the fibre optic cutting device.
Each cut opening may only be used once.
- **Adapter**
The included adapter must be used with fibre optics having a fibre diameter of 1mm.
The fibre optics must extend more than 0.5mm beyond the adapter.
- **First installation**
Before using the fibre optics for the first time, the fibre must be cut at the end to provide a smooth surface.
- Shipment is done in pairs for throughbeam (LS) applications.

Order guide

Plastic fibre optics in scanner operation

Order code	KF 2000/2 RT.4-04 Part No. 500 27782	KF 2000/2 RT.4-05 Part No. 500 27783	KF 2000/1 RT.4-06 Part No. 500 27784	KF 2000/2 RT.5-07 Part No. 500 27785
Scanning range ¹⁾	25mm	30mm	6mm	30mm
Scanning range ²⁾	65mm	80mm	15mm	65mm
Scanning range ³⁾	50mm	60mm	10mm	50mm
Fibre optics outer diameter	2mm	2mm	1mm	2mm

- 1) Scanning range in connection with LVS 420/P relative to white 90%
 2) Scanning range in connection with LVSR 325 relative to white 90%
 3) Scanning range in connection with LVSR 8 relative to white 90%